

# K2 POWER ES 165 KX2

Woofer 6<sup>1/2</sup>"



- K2 Power sandwich cone
- "TMD" surround (patented technology)
- 2 Ω
- 1<sup>9/16</sup>" (40mm) VC diameter

## SPECIFICATIONS

|                        |                 |  |
|------------------------|-----------------|--|
| Nominal power          | 120W            |  |
| Maximum power          | 240W            |  |
| Sensitivity (2,83V/1m) | 92.5dB          |  |
| Cone                   | Kevlar sandwich |  |
| Nom. impedance         | 2Ω              |  |
| Surround               | Butyl           |  |
| DC resistance          | 1.8Ω            |  |
| VC diameter            | 40mm            | 1 <sup>37/64</sup> "                     |
| Former                 | Kapton          |  |
| Layers                 | 2               |  |
| Wire                   | CCA W           |  |
| Magnet (d x h)         | 100x22mm        | 3 <sup>15/16</sup> x0 <sup>55/64</sup> " |
| Net weight             | 1700g           | 3.7lbs                                   |

## FREQUENCY RESPONSE/IMPEDANCE

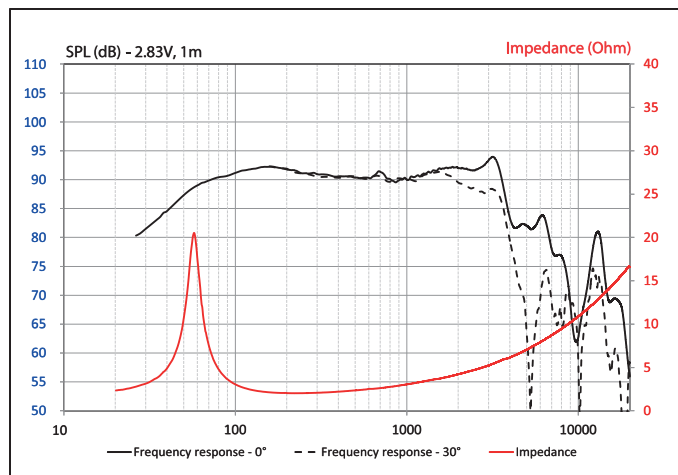

## PARAMETERS

|                  |                      |
|------------------|----------------------|
| R <sub>dc</sub>  | 1.8 Ω                |
| F <sub>s</sub>   | 55Hz                 |
| M <sub>ms</sub>  | 15.3g                |
| C <sub>ms</sub>  | 0.54mm/N             |
| V <sub>as</sub>  | 14l                  |
| Q <sub>ts</sub>  | 0.55                 |
| Q <sub>es</sub>  | 0.61                 |
| Q <sub>ms</sub>  | 5.2                  |
| B <sub>xl</sub>  | 4 N/A                |
| S <sub>d</sub>   | 128.6cm <sup>2</sup> |
| SPL              | 89.5dB               |
| X <sub>max</sub> | 5.3 mm               |

## MECHANICAL DRAWING

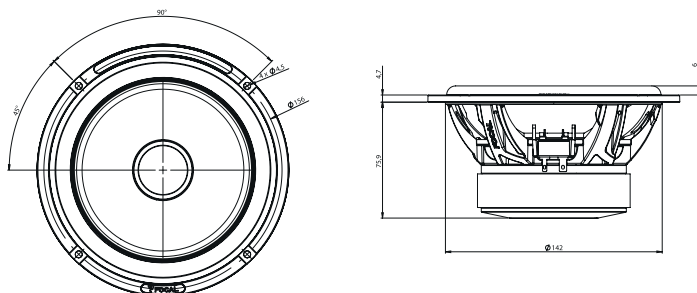

 **Elite**  
"HAUTE COUTURE" SOUND

 **FOCAL**®  
THE SPIRIT OF SOUND